

Quartz Crystal Ceramic SMD

FWQ

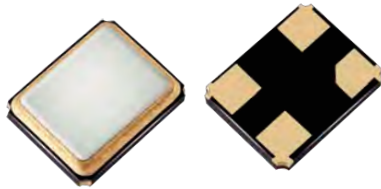

2.0 x 1.6mm Ceramic SMD

Product Features

- Rugged AT-cut crystal construction
- 2.0 x 1.6mm ceramic package
- Available on tape & reel; 8mm tape, 3000 units per reel
- Pb-free and RoHS/Green compliant
- AEC-Q200 compliant
 - Grade 3, Grade 2 & Grade 1

Product Description

The 4-pad FWQ Series seam seal devices incorporate a sub-miniature AT-cut crystal resonator housed in a standard 2.0 x 1.6mm ceramic package. These compact crystal are ideal for surface mounting in densely populated PCB applications.

Applications

- Automotive

Package: (Dimensions are in mm)

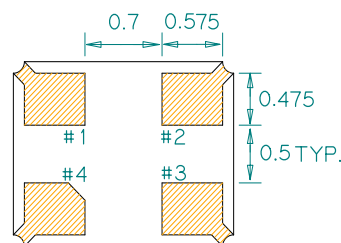
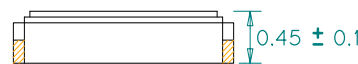
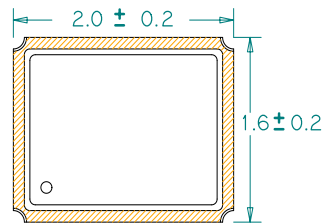

Recommended Land Pattern:

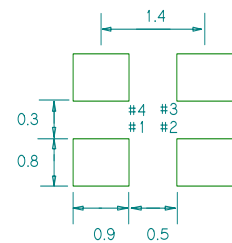

Top View:

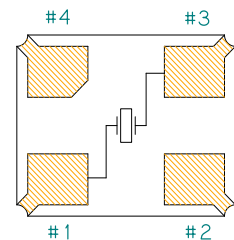

Recommended - Pin 1 & 3: Crystal
Pin 2 & 4: GND

Part Ordering Information:

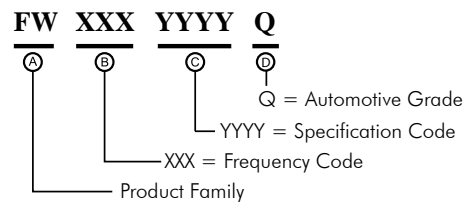

Following the above format, SaRonix-eCera part numbers will be assigned upon confirmation of exact customer requirements.