

RXO5032M



SMD Clock Oscillator

High Performance XO in 5 x 3.2 mm Surface Mount package

Product description

The RXO5032M offers ultra low RMS phase jitter in a small 5 x 3.2 mm SMD package (including a low profile 1mm height option for CMOS products). Available in hundreds of industry standard frequencies from 1MHz to 200MHz, as well as for custom frequency development.



Applications

- Base stations
- Communications
- Consumer
- DSL/ADSL
- Ethernet
- Wi-Fi
- WiMAX/W-LAN

Features

- Ultra Low Jitter 0.05 to 0.3 ps integrated 12 kHz to 20 MHz
- Excellent temperature stability
- CMOS, LVPECL, LVDS, or HCSL output options
- Wide frequency range
- Low power differential outputs
- Small form factor

Specifications

1.0 SPECIFICATION REFERENCES

Line	Parameter	Description
1.1	Model Description	RXO5032M XO
1.2	Reference Number	
1.3	Rakon Part Number	

2.0 FREQUENCY CHARACTERISTICS

Line	Parameter	Test Condition	Value	Unit
2.1	Frequency		1 to 200	MHz
2.2	Operating Temperature Range	Operable -40 to 85°C	-10 to 70	°C
2.3	Frequency Stability	Including Temperature range, Supply variation, Load variation and 10 years aging at 25°C	±30 to 50	ppm
2.4	Temperature Stability	Temperature range only	±10 to 20	ppm
2.5	Frequency Aging	First year	±3	ppm

3.0 POWER SUPPLY

Line	Parameter	Test Condition	Value	Unit
3.1	Supply Voltage (VDD)	With a tolerance of ±10%	3.3	V
3.2	Supply Voltage (VDD)	With a tolerance of ±5%	2.5	V
3.3	Supply Current	For LVCMOS (To be specified based on frequency and voltage)	6 to 40	mA
3.4	Supply Current	For LVPECL/LVDS	65 max	mA
3.5	Supply Voltage (VDD)	With a tolerance of ±10%	5	V

Drawing Name: XO 5032 4-Pin Model Drawing

PACKAGE G45

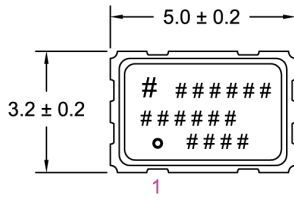

TOP VIEW

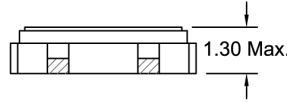

FRONT VIEW

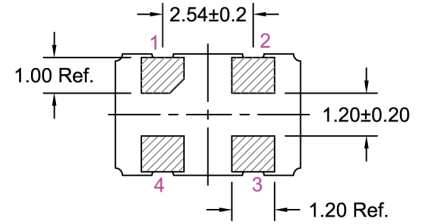

BOTTOM VIEW

PACKAGE G4L

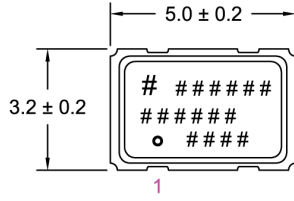

TOP VIEW

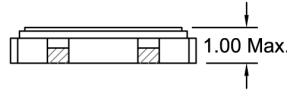

FRONT VIEW

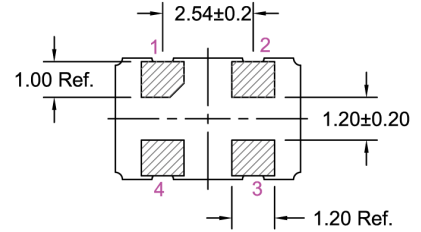

BOTTOM VIEW

NOTE : 1. PIN CONNECTIONS ARE DETAILED IN THE SPECIFICATION.
2. MARKING INFORMATION IS DETAILED IN THE SPECIFICATION.

RECOMMENDED PAD LAYOUT - Top View

PACKAGE G45 AND G4L

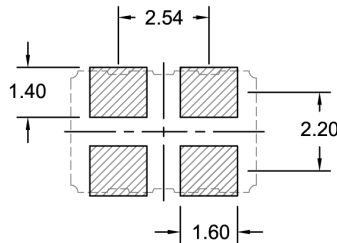

TITLE: XO 5032 4-PIN MODEL

RELATED DRAWINGS:

FILENAME: CAT686

REVISION: A

DATE: 01-May-12

SCALE: 5 : 1

Millimetres

TOLERANCES:

XX =

X.X = ±0.15

X.XX = ±0.10

X.XXX =

X° =

Hole =

rakon

© 2009 Rakon Limited

Drawing Name: XO/VCXO 5032 6-Pin Model Drawing

PACKAGE G65

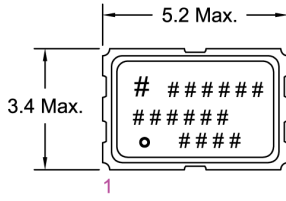

TOP VIEW

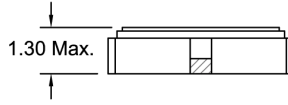

FRONT VIEW

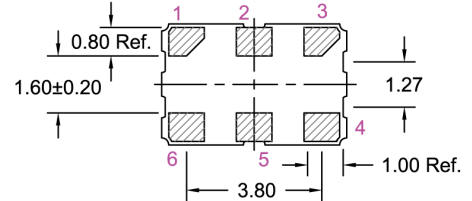

BOTTOM VIEW

PACKAGE GV5

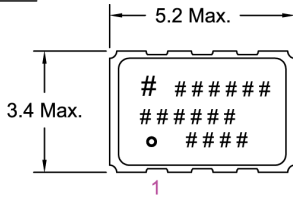

TOP VIEW

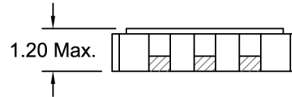

FRONT VIEW

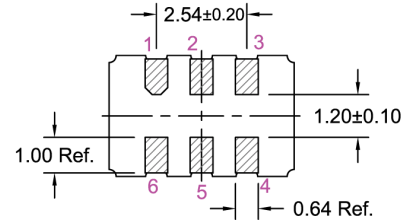

BOTTOM VIEW

PACKAGE F

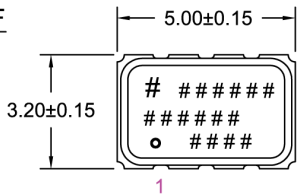

TOP VIEW



FRONT VIEW

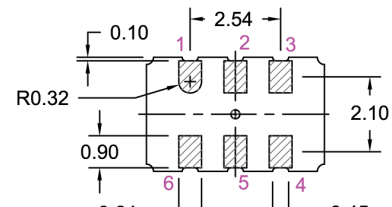

BOTTOM VIEW

NOTE : 1. PIN CONNECTIONS ARE DETAILED IN THE SPECIFICATION.
2. MARKING INFORMATION IS DETAILED IN THE SPECIFICATION.

RECOMMENDED PAD LAYOUT - Top View

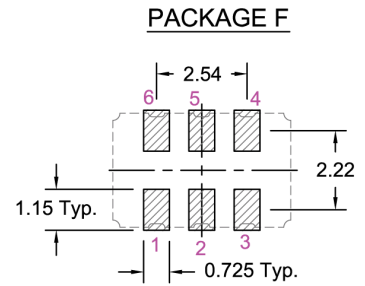
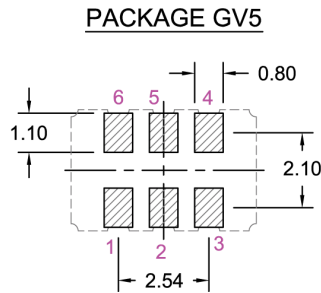
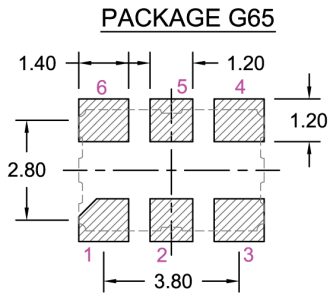

TITLE: XO/VCXO 5032 6-PIN MODEL

RELATED DRAWINGS:

FILENAME: CAT026

REVISION: C

DATE: 01-May-12

SCALE: 5 : 1

Millimetres

TOLERANCES:

XX =

X.X = ±0.15

X.XX = ±0.10

X.XXX =

X° =

Hole =

rakon

© 2009 Rakon Limited